



Together

## WE ARE CBC

Carolina Bible Camp is more than a location, buildings, or property- it is the people committed to the CBC experience and our mission to provide a safe and uplifting environment for the spiritual growth of our children and youth.

CBC has a rich history of more than 65 years of committed families, individuals, and churches, starting with a small group of visionaries in 1956 and culminating now in hundreds of dedicated volunteers and supporters. Over the course of our lifespan, God has shaped many thousands of lives, with an especially large impact in the 30+ years at our Mocksville campus.

In the last six years alone (excluding 2020), CBC has had an aggregate total of 4,892 campers and staff to participate in summer and winter camps, representing 16 states and South Korea. In that time, we have had 86 baptisms.

CBC has owned the camp property in Mocksville, NC for over 30 years and carries *no debt* while the financial controls, asset management, and operations are annually within the margins.

**Now we are dreaming together about the future of CBC!**

## CBC OVER THE LAST 5 YEARS

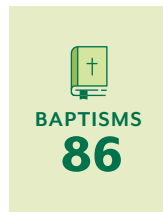

Carolina Bible Camp and Retreat Center is a 501(c)(3) not for profit organization that is led by an elected board of directors.

**The Dream Begins**  
Several visionaries began forming plans for a Bible camp in the Carolinas.  
**1956**

**15 Years at Camp Hanes**  
King, NC  
In our 15 year at YMCA's Camp Hanes, CBC grew up to 200 campers in each of its two weeks. In 1977, YMCA began using the camp exclusively for its own programs, and CBC was forced to look for other locations.  
**1962-1976**

*Camp Kanata*  
Wake Forest, NC  
**1977-1979**

*Camp Susan Barbour Jones*  
Westfield, NC  
**1981-1983**

*Woodmen of the World Camp*  
Asheboro, NC  
**1986-1991**

**First Sessions at CBC & Retreat Center in Mocksville**  
Just two years after the purchase of land, CBC began the first year at its new home with three weeks of camp.  
**1992**

**First Encampment**  
Hosted at Camp Thunderbird, the first year of camp had 125 campers.  
**1957**

**Palmetto Bible Camp formed**  
Now in Marietta, SC  
CBC was unable to accommodate more growth at Camp Hanes, so Christians in SC formed Palmetto Bible Camp.  
**1967**

*Camp Robert Vaughn*  
Walkertown, NC  
**1980**

*Camp Schaub*  
Clyde, NC  
**1984-1985**

**Land purchased in Davie Co**  
65 acres were purchased, leading the board of directors and church family from across the state to plan and build a permanent home for CBC.  
**1990**

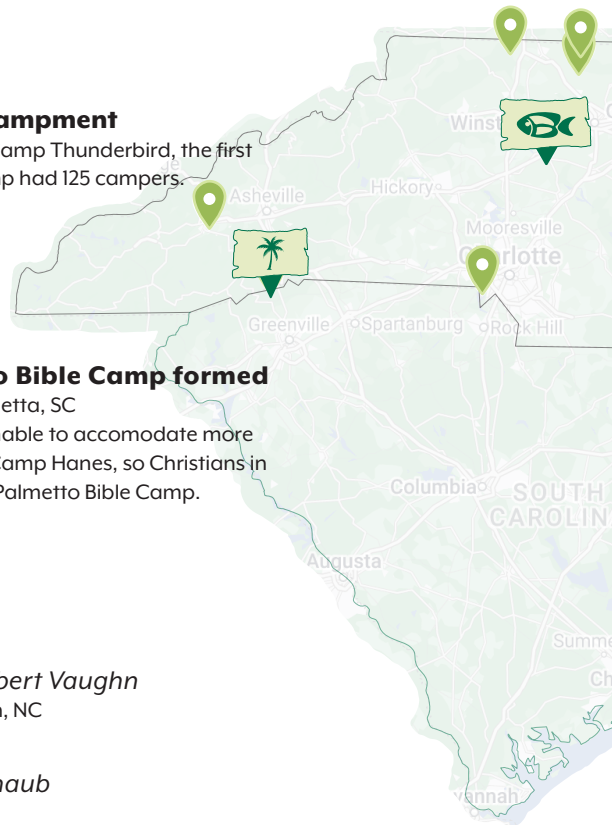

## The History of a Dream

In 1956, a group of men met in the basement of the Broad St. Church of Christ in Statesville, NC. They were concerned about the spiritual growth of the state's young people. They were thinking not only about the spiritual well-being of our youth, but also about the ongoing well-being of the church in the Carolinas.

So, they came together to talk about a dream...a big dream of establishing a summer Bible camp where our young people could come and grow in Christ in a safe and fun environment. That dream became a reality when the first sessions of Carolina Bible Camp were held in 1957! God blessed that dream as year after year the two weeks of CBC were filled to capacity.

However, something was missing: a place to call home! From 1957-1991, CBC rented camp facilities across the state, leaving us to the whims of the governing boards of those facilities.

Then, in 1990, there was an opportunity to purchase 65 acres in Davie County, NC, leading the board of directors and church family across the state to dream of a permanent home for CBC during the summer, and an opportunity to rent the campus in the off-season. With little money in the bank, a faith-inspired fundraising effort began. Only two years later, the first camp sessions were held at the new Carolina Bible Camp & Retreat Center. We were home at last!

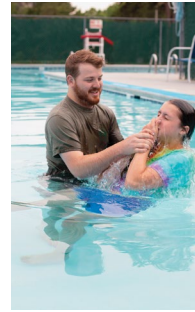
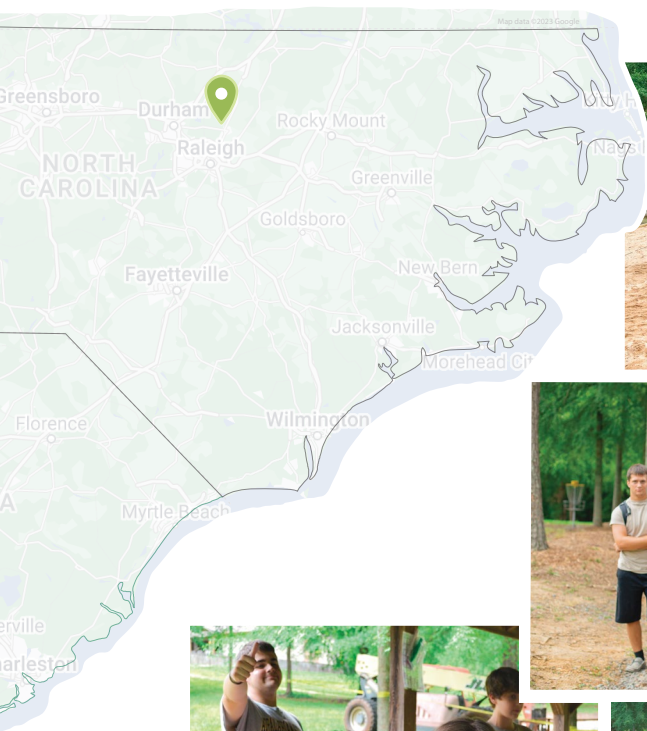

## Why Now: A New Dream

After over 30 years of hosting thousands of campers, staff, and renters, improvements and repairs need to be made. As important and needed as those things are, **WE ARE DARING TO DREAM TOGETHER** of new possibilities for our campus that will make the camp and rental experience even better for thousands of future CBCers! We want to continue contributing to the spiritual growth of our young people and serving the churches across our state. In order to be a safe and competitive camp destination for our children, youth, and families, the time for updates and repairs is NOW!

We have been dreaming about a multipurpose building and big repairs for several years, and each year that we wait only adds additional costs to its construction.

But ultimately, we would ask, "Why not now?" We are a people of faith, and we believe that our God "is able to do immeasurably more than all we ask or imagine, according to His power that is at work within us..." (Eph 3:20). Yes it is a big project, but...

*Together,*  
by the power of God, we can!

# Phase 1

## FACILITY & CAMPER EXPERIENCE IMPROVEMENTS

**\$500,000 OVER 1 YEAR**

### AMPHITHEATER REBUILD

The current amphitheater is getting a complete rebuild. A newly equipped amphitheater will provide an optimal setting for worship, classes, conferences, weddings, and other events.

### DINING HALL AND KITCHEN EXPANSION

Current kitchen and storage areas are barely adequate. The dining hall is in need of new tables and chairs. The dining hall basement will be water-proofed and enclosed for gatherings.

### LOW ROPES COURSE

A low ropes course will provide an additional recreation activity for campers as well as training in leadership and teamwork skills. It would also serve as an incentive for local groups to use our facility for leadership and teamwork training.

### CABIN REPAIRS

Current and near future repairs include new roofs and new flooring in the bathrooms.

### NURSE'S CABIN REPAIRS

The fully functioning nurse's cabin is integral to the safety of CBC's campers and staff. The current building needs an additional entrance, waterproofing, and environmental treatment.

### LODGE ENHANCEMENTS

The lakeside lodge needs additional meeting space for campers and retreat rentals, to be accomplished by completing the basement. Additional parking is needed in order to make the lodge more amenable to event rentals.

### CAMP EXPERIENCE REPAIRS

The camper's experience lies at the heart of the Together Campaign. Included in the project will be resurfacing of the basketball court and providing new playground equipment.

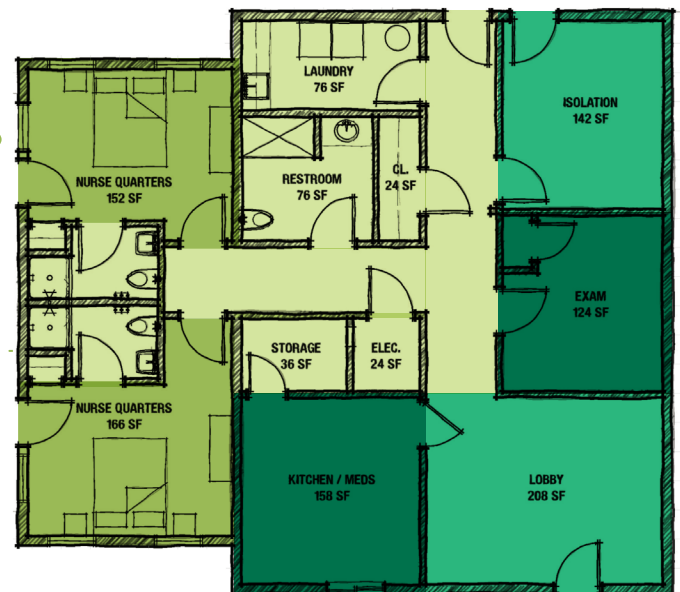
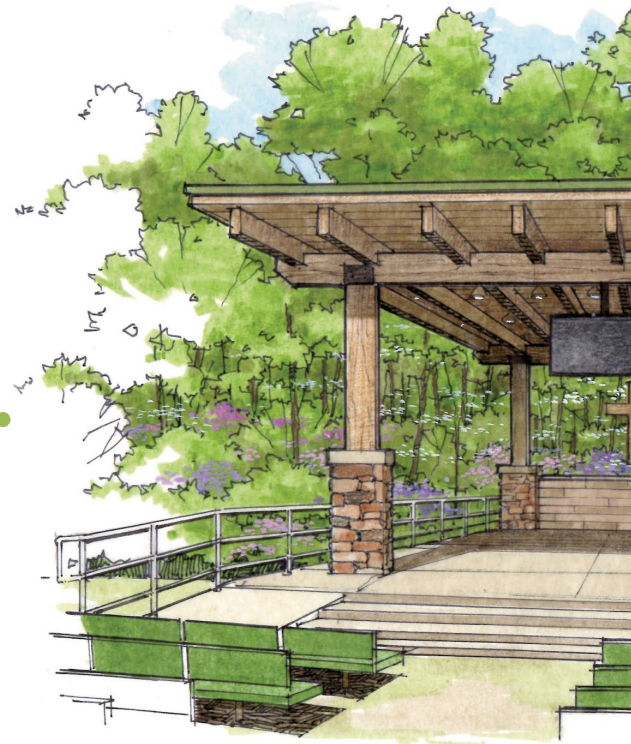

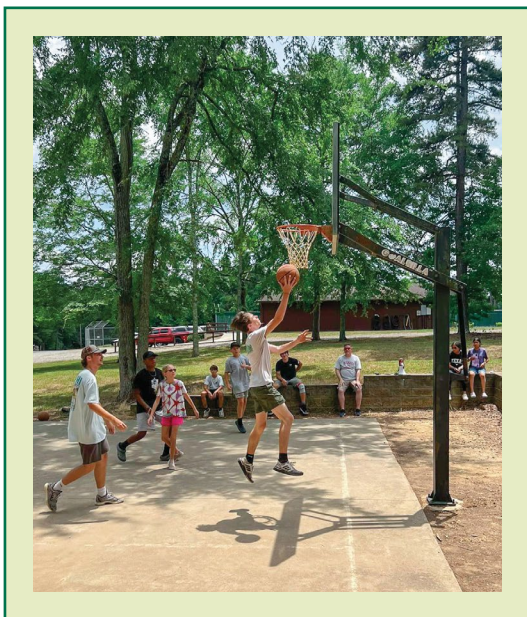

## **CAPITAL BUDGET TOTAL \$500,000**

### **PHYSICAL PLANT \$413,500**

#### **New Construction \$150,000**

##### **Amphitheater \$120,000**

- Seating (materials only) \$20,000
- A/V \$20,000
- Structure \$65,000
- Grounds Improvement \$15,000

##### **Camp Experience/Offerings \$30,000**

- Low Ropes Course \$30,000

### **Facility Improvements \$263,500**

#### **Dining Hall \$160,000**

- Pantry Expansion/Ramp \$22,000
- Cafeteria Extend Front Storage Rooms \$30,000
- Waterproof basement \$25,000
- Finished space in basement \$75,000
- Round Tables/Chairs (Dining) \$8,000

#### **Cabins \$30,000**

- Metal Roofs \$25,000
- Linoleum Flooring (bathrooms) \$5,000

#### **Nurses Cabin \$30,000**

- Repair/Add rear exit \$30,000

#### **Lodge Improvements \$15,000**

- Basement Refinish \$5,000
- Parking \$10,000

#### **Camp Experience Improvement \$28,500**

- Basketball court resurfacing \$25,000
- Playground Structure \$3,500

### **PROGRAMMING \$86,500**

- Training \$15,000
- Scholarships \$56,500
- Technology \$15,000

*The Time is Now.*

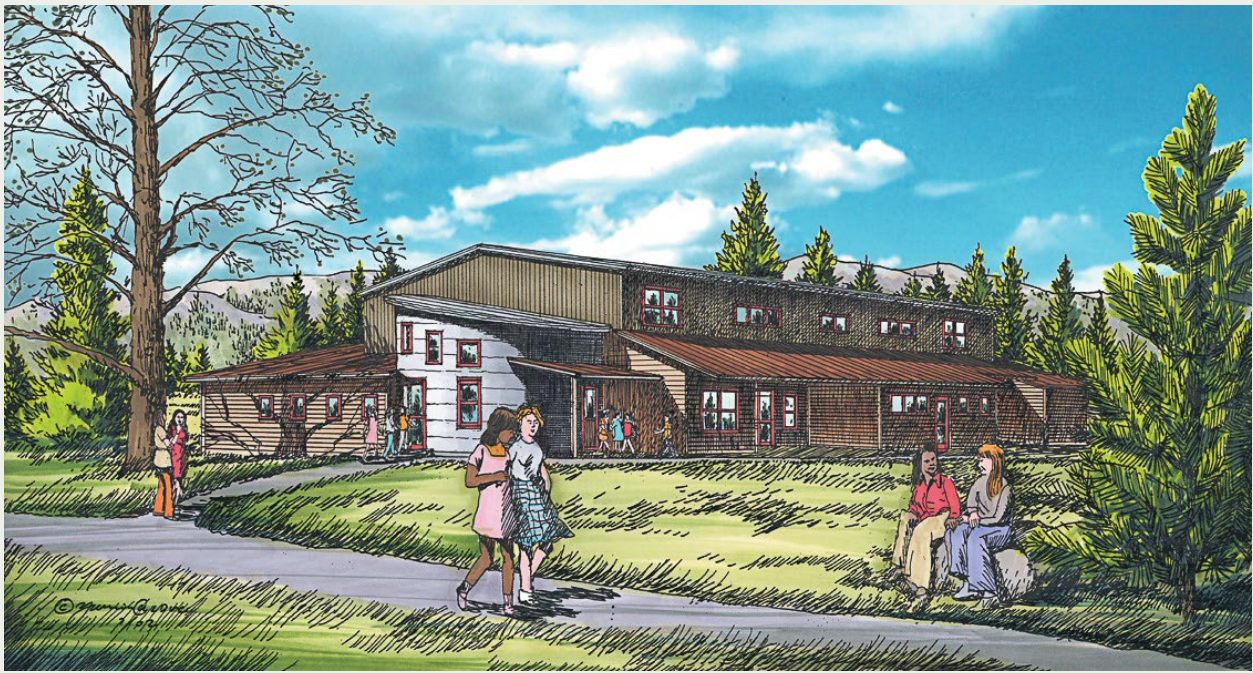

POSSIBLE RENDERINGS

# Phase 2

## MULTI-PURPOSE BUILDING

COMING IN 2024/2025

Once Phase 1 fundraising is completed, we will then undertake Phase 2 for the greatly needed multi-purpose building. With tremendous variability in building costs, the Phase 2 final costs and renderings of the building will be shared closer to the start time.

### MULTI-PURPOSE BUILDING

The future centerpiece of this campaign is the construction of a new 12,000-18,000 square foot, state of the art multi-purpose building! This facility will provide additional spaces for recreation, worship, and gatherings. It will also provide lodging for 16 people, break-out classrooms, and a staff workroom. The new multi-purpose building will be an ideal destination for retreats and rentals by church groups, corporate teams, and large gatherings of any kind.

### POSSIBLE FEATURES

- Large Gym Area with Bleachers
- Indoor and Outdoor Stages
- Multiple Classrooms
- Kitchen
- Lodging for 16 People
- Staff Workroom
- Additional Storage Space

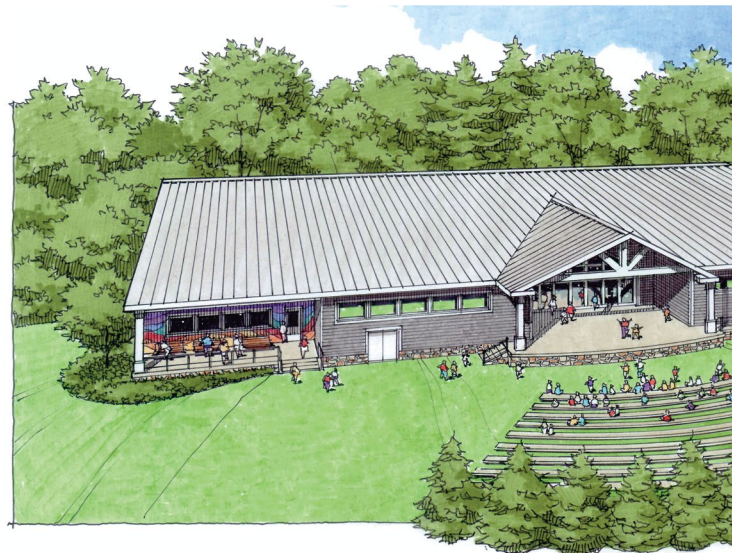
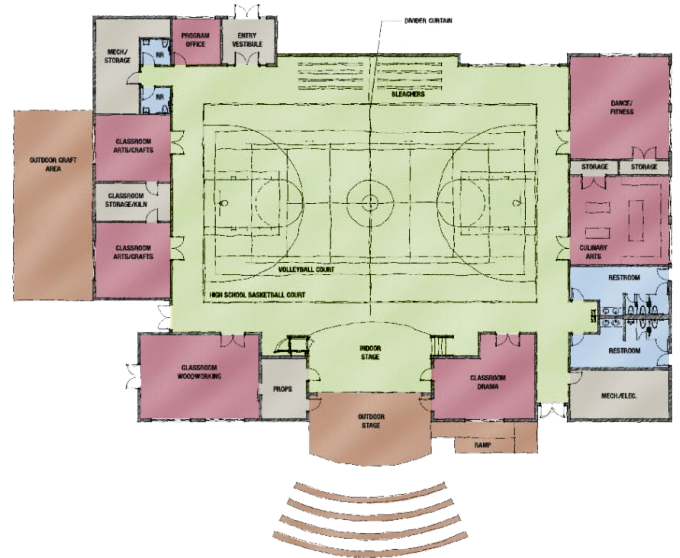

## The Invitation

While we don't know exactly how God will send the funds needed to complete this project, experience and wisdom tell us that we will need leadership gifts to fund the vision to provide a safe and uplifting environment for our children and youth's spiritual growth.

This table represents our strategic plan for accomplishing our fundraising goals over a one year pledge period for Phase 1. God has always richly blessed CBC with all that we have needed

to teach and disciple young people. We firmly believe that God will provide the resources needed to successfully reach this new goal.

The CBC "Together" campaign is a broad church and community effort that will need the investment of more than 300 supporters. Every gift—from the youngest of givers among us to the oldest—helps us reach our goal and has an impact on the faith and spiritual development of our children and youth.

LEVEL	# GIFTS	MONTHLY GIFT	TOTAL LEVEL	COMPOSITE	% OF TOTAL
\$75,000	1	\$6,250	\$75,000	\$75,000	15%
\$50,000	2	\$4,167	\$100,000	\$175,000	35%
\$25,000	3	\$2,083	\$75,000	\$250,000	50%
\$10,000	5	\$833	\$50,000	\$300,000	60%
\$7,500	7	\$625	\$52,500	\$352,500	71%
\$5,000	10	\$417	\$50,000	\$402,500	81%
\$3,000	20	\$250	\$60,000	\$642,500	93%
<\$3,000	MANY	\$5-\$249	\$37,500	\$500,000	100%

## The Future

From the visionaries in 1956 to the dedicated dreamers of today, all those who have loved CBC share a common mission to serve the local children and youth, helping them become faithful followers of Christ Jesus.

A first-time junior camper in 2023 could  
 in 2027 be a senior camper,  
 in 2034 be a counselor,  
 in 2039 be a teacher,  
 in 2049 be a head counselor,  
 in 2052 bring their own child to camp,  
 in 2061 become a director, and  
 in 2079 bring their grandkids to camp.

That's **66 more** years our families can continue being blessed by God at Carolina Bible Camp.

*Together,*  
**by the power of God, we can!**



**We want the CBC  
 experience to continue  
 for many generations!**

**We want our  
 grandchildren and  
 great-grandchildren to  
 be able to come to CBC  
 as long as we have- as  
 kids, teens, and adults.**

**We want our campus to  
 continue blessing our  
 community for many  
 years to come!**

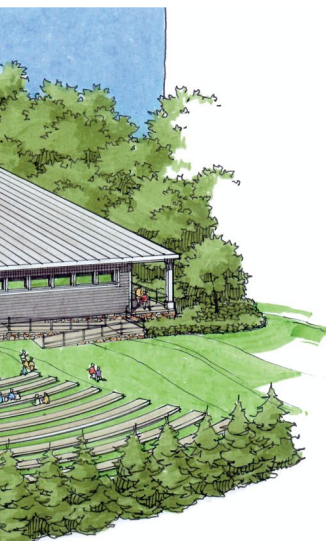



# A Future Together



100 YEARS of CBC

## Dennis Conner

Junior Camper: 1963-66  
 Senior Camper: 1967-1973  
 Athletic Director,  
 Education Director,  
 Counselor: 1974-1988  
 Teacher: 1974- present  
 Weekly Director: 1988-2022  
 Board Member: 1982-present  
 Teacher: 2010-present  
**Brought my grandkids: 2017-present**



## Andrea Clauset

Pre Camper: 1983-1984  
 Junior Camper: 1985-88  
 Senior Camper: 1989-1994  
 Team Leader,  
 Counselor, Teacher: 1994-present  
**Brought my kids: 2017-present**



## Truett Branch

1st Time Junior Camper: 2023  
 Future Junior Camper: 2024-2026  
 Future Senior Camper: 2027-2033  
 Future Junior Counselor: 2030-2031  
 Future Counselor: 2034-2045  
 Future Head Counselor: 2045-2058  
 Future Teacher: 2059-2068  
 Future Director: 2070-2079  
**Will bring his kids: 2051-2068**  
**Will bring his grandkids: 2083-2094**

